

Scottish Borders Council
 Town & Country Planning (Scotland) Act
 REFUSED
 20 AUG 2007
 Planning & Economic
 Development Department

RECEIVED - 9 FEB 2007

This is a true copy of the Building
 Warrant / Planning
 Application
 Dated
 Signed
 DTA Chartered Architects

NOTES
 1. Do NOT scale from this drawing
 2. All dimensions to be confirmed by
 the Contractor by site measure prior
 to work commencing, or fabrication
 or ordering of any components.
 3. In the case of any discrepancy,
 always refer to the Architect.

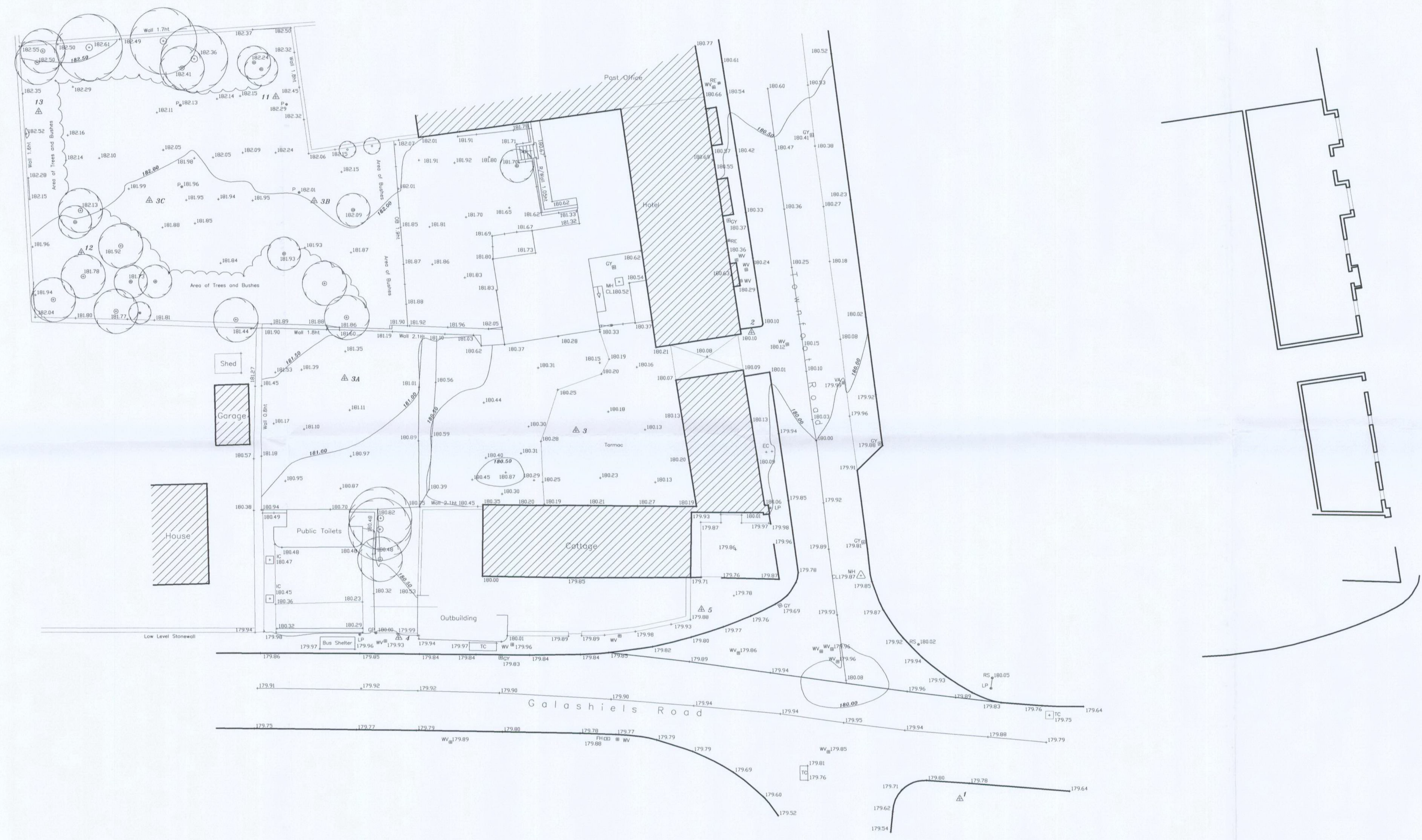

Client
 lochpark builders

Project
 Royal Hotel Stow

Title
 Existing Topographical
 survey

job no
 B42-01

drg no
 L(2)-12

date by scale
 Sep 02 GT 1:200

Autocad Reference

DTA
 CHARTERED
 ARCHITECTS

Elizabeth Court
 4 Stuart Street
 The Village
 East Kilbride
 Glasgow G74 4NG
 Tel: 01355 260909
 Fax: 01355 260906